



CITY OF TERRACE

PUBLIC NOTICE

OF

APPLICATION FOR DEVELOPMENT VARIANCE PERMIT

TAKE NOTICE THAT an application has been made for a Development Variance Permit.

TAKE NOTICE ALSO THAT the application affects the property and land within the City of Terrace at **4812 Highway 16 W** shown hatched and in bold outline on the attached map.

PURPOSE:

To vary Section 6.6.3. of Sign Bylaw No. 2102-2016 to increase the Maximum Total Sign Area from 25 square meters to 41.04 square meters for the subject property.

The subject property is zoned C3 – Service Commercial. This permit is being considered to allow additional commercial signage for the property.

The proposed **Development Variance Permit may be inspected** in the reception area at the City of Terrace PUBLIC WORKS BUILDING at 5003 Graham Avenue, Terrace, B.C. between the hours of 9:00 a.m. and 4:00 p.m., each day, from Monday to Friday, excluding Statutory Holidays. For enquiries concerning this application contact the Planning Department at 250-615-4022.

The application will be considered by Council at the April 13, 2026, Regular Council Meeting at 7:30 p.m. in Council Chambers. Any person who wishes to address Council may do so in person at 3215 Eby Street or participate virtually through Microsoft Teams. Council meetings will also be live streamed and available for viewing on the City of Terrace website at www.terrace.ca/city-hall/council-webcasts or on the City of Terrace Facebook page.

Participate Virtually – www.terrace.ca/participate

Contact Planning Department – Phone: 250-615-4022

Written submissions – Email: developmentsservices@terrace.ca or by letter, mailed or delivered to: 5003 Graham Avenue, Terrace, B.C., V8G 1B3

Written submissions **must be received prior to 11:00 a.m. on Monday, April 13, 2026**, in order to be considered by Council.

THIS NOTICE IS GIVEN IN ACCORDANCE WITH THE LOCAL GOVERNMENT ACT, R.S.B.C., 2015 (and amendments thereto), UNDER SECTIONS 498 and 499.

TAKE NOTICE AND BE GOVERNED ACCORDINGLY.

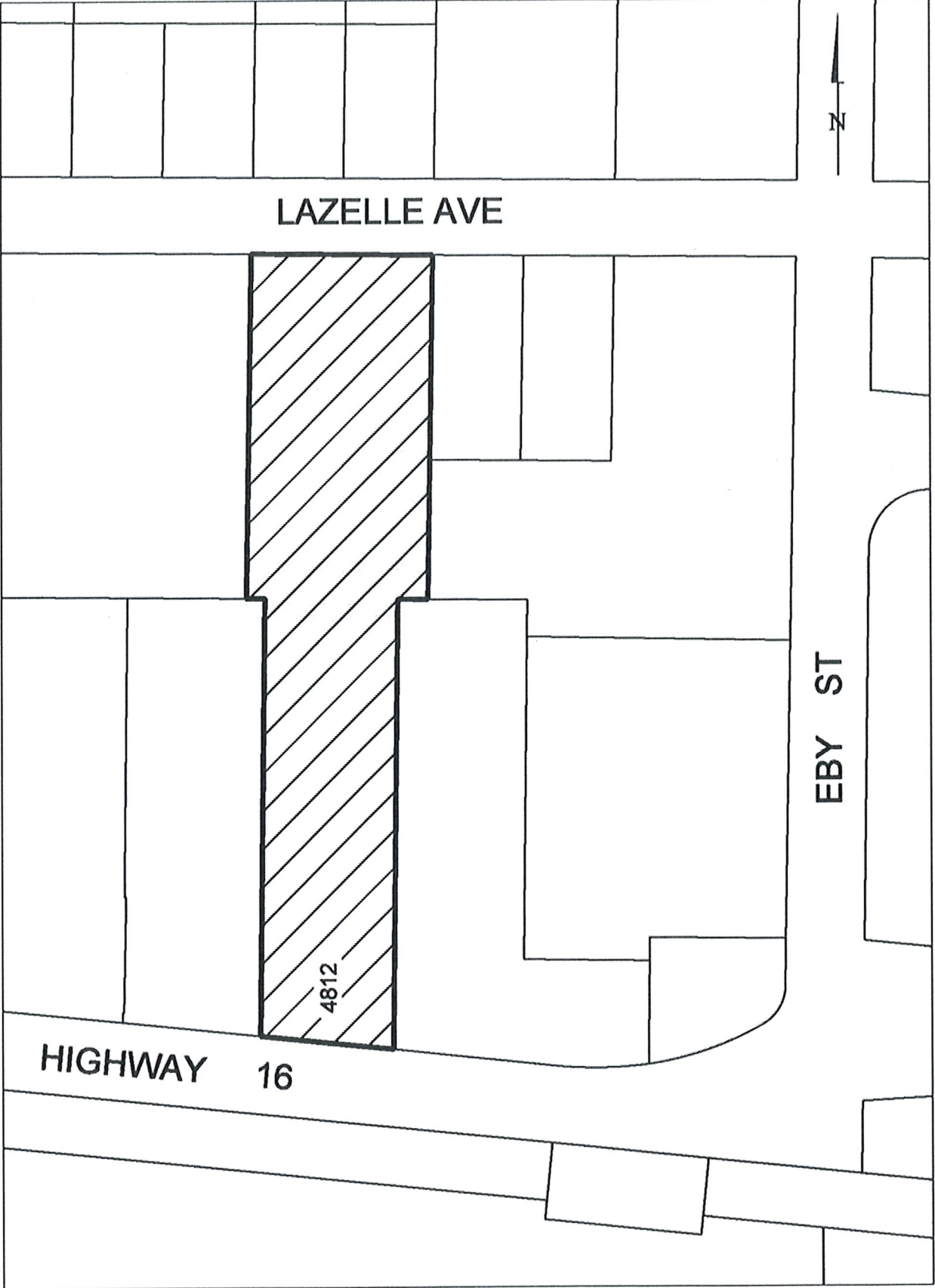

LAZELLE AVE

EBY ST

HIGHWAY 16

4812

